

1717 NE BAYSHORE DR A-2736 MIAMI FL 33132

https://www.cays.com

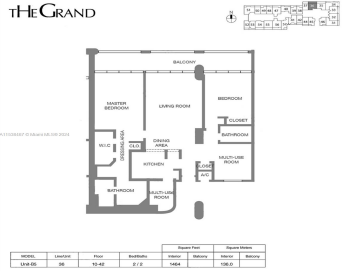

\$738,500



Spectacular water views from the 27th floor and a large balcony overlooking Biscayne Bay and Margaret Pace Park. Both bedrooms and living room have water views. Over 1,400 Sf 2 bedrooms & 2 bathrooms plus a large den (window and closet), Kitchen with a pantry, and good quality kitchen and bathrooms. This property allows [...]

- 2 beds
- 2 baths
- Condominium
- Residential
- Active
- 1464 sq ft

Basics

Bathrooms Full: 2
Category: Residential
Status: Active
Bathrooms: 2 baths
Year built: 1986

Lot Size Units: Square Feet
Type: Condominium
Bedrooms: 2 beds
Area: 1464 sq ft



Property details

Total Building Area: 1464

Direction Faces: Northeast

Subdivision Name: VENETIA CONDO

Parcel Number: 01-32-31-048-0186

Possession: Close Of Escrow

Property Features

Building Features: Exterior Lighting

Exterior Features: Balcony, Tennis Court(s), Security/High Impact Doors

Interior Features: Bedroom on Main Level, Kitchen Island, Living/Dining Room, Custom Mirrors, Main Level Primary, Pantry, Split Bedrooms, Separate Shower, Walk-In Closet(s), Elevator, Bar

Laundry Features: Common Area

Waterfront Features: Bay Front

Window Features: Impact Glass

Pool Features: Association, Heated

Parking Features: One Space

Security Features: Door Man, Key Card Entry, Lobby Secured, Fire Sprinkler System, Smoke Detector(s)

Appliances: Dryer, Dishwasher, Electric Range, Electric Water Heater, Disposal, Ice Maker, Microwave, Refrigerator, Self Cleaning Oven, Washer

Architectural Style: High Rise

Association Amenities: Bike Storage, Fitness Center, Laundry, Other, Pool, Sauna, Trash, Elevator(s)

Construction Materials: Block

Cooling: Central Air

Cooling Y/N: 1

Covered Spaces: 1

Flooring: Ceramic Tile, Other

Furnished: Unfurnished

Garage Spaces: 1

Garage Y/N: 1

Heating: Central

Heating Y/N: 1

Pets Allowed: Size Limit, Yes

View: Bay, City, Garden

View Y/N: 1

Entry Level: 27

Entry Location: 27

Patio and Porch Features: Balcony, Open

Waterfront Y/N: 1

Stories Total: 42



Rooms & Units Description

Unit Number: A-2736

Total Rooms: 4

Location Details

County Or Parish: Miami-Dade County

Elementary School: Wheatley; Phyllis

Middle/Junior School: de Diego; Jose

High School: Young Mans Prep Academy

Fees & Taxes

Tax Annual Amount: 8684

Tax Year: 2023

Tax Legal Description: THE
GRAND FKA VENETIA UNIT
A-2736 UNDIV .1132509 INT IN
COMMON ELEMENTS OFF REC
12917-280 AMDT NAME CHG OR
14490-266 OR 15102-2960 0691
1

Association Fee: 1041

Association Fee Frequency:
Monthly

Association Fee Includes: Amenities,Common
Areas,Insurance,Laundry,Parking,Pest
Control,Pool(s),Roof,Sewer,Security,Trash,Water

Miscellaneous

Public Survey Township: 2

**Public
Survey
Section:** 31

Syndication Remarks: Over 1,400 Sf 2 bedrooms & 2 bathrooms plus a large den. Kitchen with a pantry, and good quality kitchen and bathrooms. Call for appointment

**Year Built
Details:**
Effective Year
Built

Virtual Tour URL:

<https://www.propertypanorama.com/instaview/mia/A11538487>



Courtesy of

Office Name: Private Key Realty

