

# 1965 OCEAN DR HALLANDALE BEACH FL 33009 1965 S OCEAN DR 11C

<https://www.cays.com>

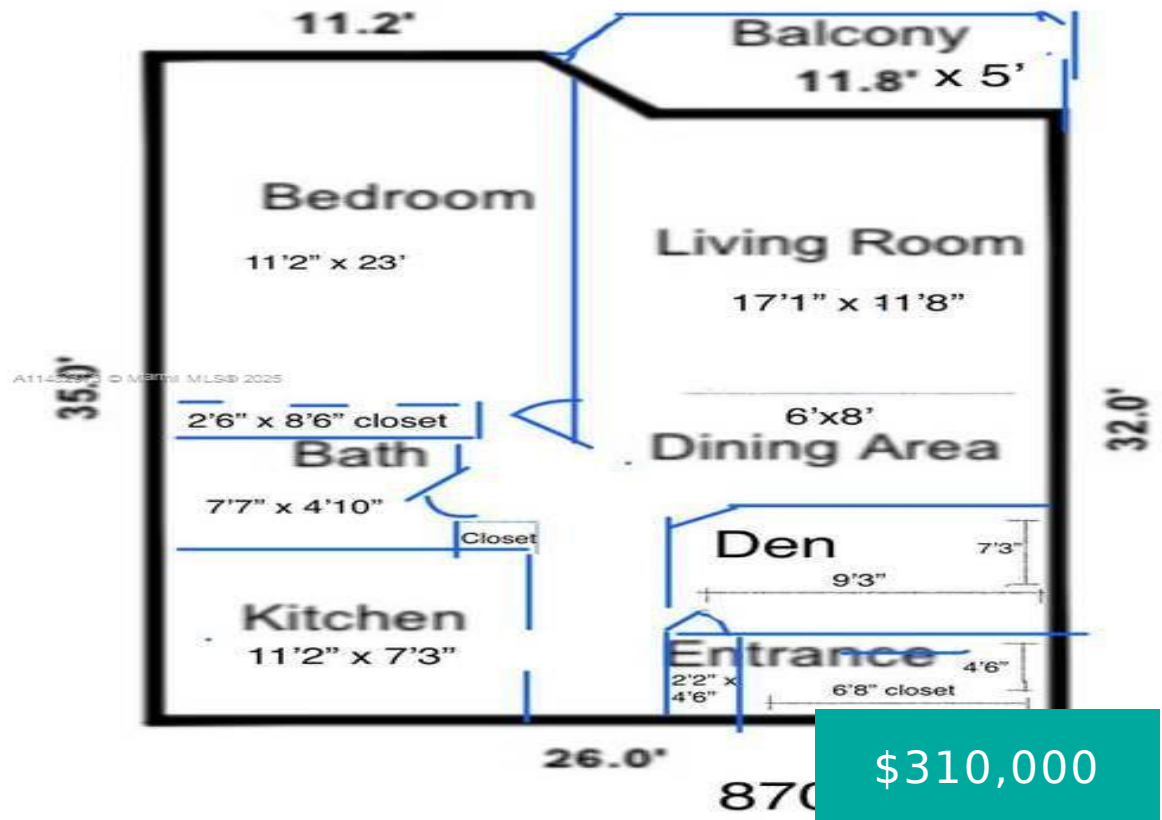

**\$310,000**



THE HEMISPHERES CONDO UNIT 11 C BAY NORTH BLDG PER CDO BK/PG:  
 4165/352 Breathtaking Ocean and Bay views!! SE exposure high floor. Large balcony, overlooking Bay, Ocean and pool. Move in condition, recently upgraded, painted, fully furnished, spacious & bright unit. Excellent to make your Own, vacation place, easy to rent. Lots of closets, All [...]

- 1 bed
- 1, 1 bath
- Condominium, Residential
- Condominium, Residential
- Active
- 798 sq ft

## Basics



**Category:** Condominium, Residential  
**Status:** Active  
**Bathrooms:** 1, 1 bath  
**Floors:** 19 floors  
**Year built:** 1970  
**Subdivision Name:** HEMISPHERES CONDO

**Type:** Condominium, Residential  
**Bedrooms:** 1 bed  
**Half baths:** 0 half baths  
**Area:** 798 sq ft  
**View:** Bay,Intercoastal,Ocean,Pool,TennisCourt  
**County:** Broward

---

## Property details

**Subdivision Name:** HEMISPHERES CONDO

**Parcel Number:** 33009

---

## Property Features

**Waterfront Features:**  
Bayfront,IntracoastalAccess,OceanAccess,OceanFront

**Cooling:** CentralAir

**Garage Y/N:** 1

**Heating Y/N:** 1

**View:** Bay,Intercoastal,Ocean,Pool,TennisCourt

**Waterfront Y/N:** 1

**Parking Features:**  
Detached,Garage,Open,OneSpace,Valet

**Cooling Y/N:** 1

**Heating:** Central

**Pets Allowed:** Conditional,Yes

**View Y/N:** 1

**Stories Total:** 19

---

## Rooms & Units Description

**Unit Number:** 11C

---

## Location Details

**County Or  
Parish:**  
Broward

**Directions:** Driving Directions:Hallandale Beach Blvd east down to the ocean, turn right, make right on 4th light, up the ramp, bldg is on your right. Broker Remarks: Easy to show. No Tenant, lockbox, call agent for appointment.



---

# Building Details

**Architectural Style:** HighRise

**Covered Spaces:** 1

**Floor covering:** CeramicTile

**Construction Materials:** Block

**Garage Spaces:** 1

---

## Amenities & Features

**Pool Features:** Heated

**Security Features:** ComplexFenced,ElevatorSecured,KeyCardEntry,SmokeDetectors

**Accessibility Features:** AccessibleElevatorInstalled,Other

**Waterfront Features:** Bayfront,IntracoastalAccess,OceanAccess,OceanFront

**Window Features:** Blinds

**Electric:** Fuses

**Furnished:** Furnished

**Interior Features:** BedroomOnMainLevel,BreakfastArea,EatInKitchen,LivingDiningRoom,MainLivingAreaEntryLevel,TubShower,Elevator

**Appliances:** SomeGasAppliances,Dishwasher,Microwave,Refrigerator,TrashCompactor

**Parking Features:** Detached,Garage,Open,OneSpace,Valet

**Patio & Porch Features:** Balcony,Deck,Open

**Association Amenities:** BoatDock,FitnessCenter,Laundry,Barbecue,PicnicArea,Playground,Pool,ShuffleboardCourt,Sauna,Storage,TennisCourts,Trash,TransportationService,Elevators

**Utilities:** CableAvailable

**Cooling:** CentralAir

**Exterior Features:** Balcony,Barbecue,Deck,Fence,TennisCourts

**Heating:** Central

**Laundry Features:** CommonArea

---

# Expenses, Fees & Taxes

**Association Fee:** \$765

**Tax Annual Amount:** \$4,497

**Tax Year:** 2022

---

# Fees & Taxes

**Association Fee:** 765

---

# Miscellaneous

**Association Fee Frequency:** Monthly **List Office Name:** Exclusively Baronoff Rlty LLC

**Listing Terms:** Cash,Conventional **Direction Faces:** Southeast

---

# Miscellaneous



**Above** **Virtual Tour URL:**

**Grade** <https://www.zillow.com/view-imx/9fbcbb8a-1ca4-434f-ae41-5449a2838720?setAttribution=mls&wl=true&initialViewType=pano>

**Finished**

**Area:**

Hallandale

Beach, FL

---

## Courtesy of

**Office Name:** Exclusively Baronoff Rlty LLC

